



## Aluminium Heat Treater Anode

Aluminum heat treater anodes are sacrificial anodes installed in heat treaters, pressure vessels and other production vessels, which are compact and easy to be replaced periodically.

It's an optimum solution for cathodic protection in relatively high temperature and low chloride saltwater environments. The most common types are in the shapes of cylindrical and spherical.

A threaded steel core is centered into the cylindrical anode for supporting and mounting. Eyebolt core is also available upon request. The extended end of the steel core could be hung and mounted on the top of the tank or vessel. Furthermore, it's also welded with the lead cable and completely sealed by epoxy at the joint.

Office: +86(574)8388 2233

Dongxi, Xinqiao, Xiangshan  
Ningbo 315725, P.R.China

[info@yuxi-anode.com](mailto:info@yuxi-anode.com)

[www.yuxi-anode.com](http://www.yuxi-anode.com)

## APPLICATION

---

- ▶ Heat Treaters
- ▶ Pressure Vessels
- ▶ Produced Water Tanks
- ▶ Oil-water Separators



## FEATURES

---

- ▶ Plastic head for easy installation
- ▶ Uniform structure for evenly distributed current
- ▶ Perfect core eccentricity ensuring uniform consumption
- ▶ Wooden reel packing for easy transportation and unfolding in field

## ELECTROCHEMICAL PROPERTIES

<b>Open Voltage (-V)</b>	1.10~1.15
<b>Closed Voltage (-V)</b>	1.05~1.12
<b>Current Capacity</b>	1135A.h/lb(2500A.h/kg)
<b>Consumption Rate</b>	7.6lbs/amp.yr
<b>Current Efficiency</b>	85% Min
<b>Solubility</b>	Solute Uniformly

Element	GALVALUM III
	Al-Zn-In-Si
Zinc(Zn)	2.0~6.0%
Indium(In)	0.01~0.02%
Cadmium(Cd)	0.002% Max
Silicon(Si)	0.08~0.20%
Iron(Fe)	0.13%
Copper(Cu)	0.006% Max.
Others Total	0.10% Max.
Aluminum(Al)	Remainder

## SPECIFICATIONS

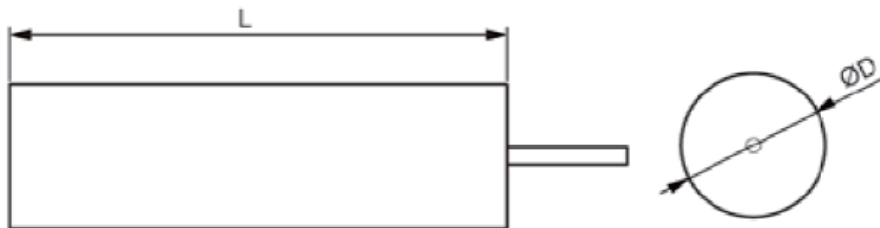

Anode Model	Anode Weight		Anode Size		Steel Core Type
	Net Weight	Gross Weight	Diameter	Anode Length	
YX-AL-R30	18.52lbs (8.4kg)	22lbs (10kg)	3" (76.20mm)	30"(762mm)	3/4" -10 UNC STUD
YX-AL-R60	37.00lbs (16.8kg)	44lbs (20kg)	3" (76.20mm)	60"(1524mm)	3/4" -10 UNC STUD

<b>Anode Model</b>	<b>YX-AL-B47 (Bowling Ball Anode)</b>
Anode Diameter	9.84"
Net Weight	47.80lbs (21.70kg)
Gross Weight	49.50lbs (22.50kg)
Core Type	1" schedule 80 Pipe Core with 1" NPT, extended 4" on top

